

E-Z TRENCH[®]

Owners Manual



Bedscaper[™] EZ-8000

E-Z Trench Manufacturing Co., Inc.
2315 S. Hwy. 701 • Loris, S.C. 29569
(843) 756-6444
Fax (843) 756-6442

A WORD TO E-Z TRENCH OWNERS . . .

THIS MANUAL HAS BEEN PREPARED TO ACQUAINT YOU WITH THE ASSEMBLY, OPERATION AND MAINTENANCE OF YOUR E-Z TRENCH TRENCHING MACHINE, AND TO PROVIDE SAFETY INFORMATION. WE URGE YOU TO READ IT CAREFULLY AND FOLLOW THE RECOMMENDATIONS CONTAINED TO HELP ASSURE THE MOST TROUBLE-FREE OPERATION.

WE WOULD LIKE TO TAKE THIS OPPORTUNITY TO THANK YOU FOR CHOOSING E-Z TRENCH, AND TO ASSURE YOU OF OUR CONTINUING INTEREST IN YOUR NEEDS.

INDEX

1. A WORD TO E-Z TRENCH OWNERS
2. OPERATING INSTRUCTIONS.
3. BOLT SIZES
4. PARTS DRAWING
5. PARTS LIST
6. TERMS AND WARRANTY
7. WARRANTY REGISTRATION
8. TROUBLE SHOOTING
9. MAINTENANCE

WARNINGS! & SAFETY PRECAUTIONS

1. ALWAYS WEAR EYE PROTECTION.
2. STAY CLEAR FROM CUTTING BLADES.
3. KEEP HANDS AND FEET AWAY FROM PULLEYS AND BELTS WHEN ENGINE IS RUNNING.
4. LOCATE ALL UNDERGROUND POWER LINES, GAS LINES, AND WATER LINES BEFORE USING MACHINE.
5. ENGINE R.P.M SHOULD REMAIN AT 3800 R.P.M.

E-Z 8000 OPERATION INSTRUCTIONS

1. INSTALL HANDLE (8160) WITH 2 BOLTS.
2. FILL CRANKCASE WITH OIL. FOLLOW INSTRUCTIONS OF ENGINE MANUFACTURER.
3. START ENGINE.
4. ENGAGE BELT DRIVE UNIT WITH HAND LEVER TO ROTATE DIGGING BLADE.
5. SLOWLY LOWER THE BLADE BY TURNING DEPTH ADJUST CRANK (8012) UNTIL DESIRED DEPTH IS REACHED.
6. PULL THE MACHINE BACKWARD. BEGIN TRENCHING SLOWLY UNTIL FAMILIAR WITH THE MACHINE AND SOIL CONDITIONS.
7. TO PREVENT CLOGGING, KEEP INSIDE OF HOUSING CLEAN.
8. NOTE: PROPER BELT TENSION, 1/8" OR WHEN A DIME WILL FIT SNUGLY BETWEEN COIL SPRING.
CAUTION: DO NOT OVER TIGHTEN BELT. (See Illustration.)

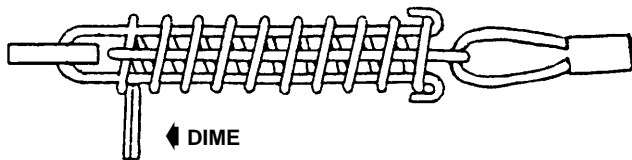

ADJUST BELT TENSION WITH (8180) QUICK ADJ. ASSY.

BOLT SIZES FOR EZ8000 BEDSCAPER

<u>PART #</u>	<u>QTY.</u>	<u>SIZE</u>	<u>ATTACHES PART...</u>
516134	2	5/16 x 1 3/4	8160 to frame
14234	1	1/4 x 2 3/4	8048A to 8160
14234	1	1/4 x 2 3/4	8180 to 8160
382	1	3/8 x 2	8048B to 8013
51634	1	5/16 x 3/4	EZ20 to EZ15
516134	1	5/16 x 1 3/4	EZ15 to 8160
38214	1	3/8 x 2 1/4	8048A to 9001
125	2	1/2 x 5	8200 to EZ317
516134	4	5/16 x 1 3/4	engine to frame
51612C	2	5/16 x 1/2	(carriage bolt) 8051
1458	6	1/4 x 5/8	8120
516134	2	5/16 x 1 3/4	8125
1434	8	1/4 x 3/4	8250
38134	1	3/8 x 1 3/4	EZ43
38112	1	3/8 x 1 1/2	EZ70
14114	1	1/4 x 1 1/4	8012 to 8014
1438ss	2	1/4 x 3/8	set screws for 385
14516ss	2	1/4 x 5/16	set screws for EZ40

E-Z-TRENCH®

843-756-6444

Bedscaper™ EZ-8000

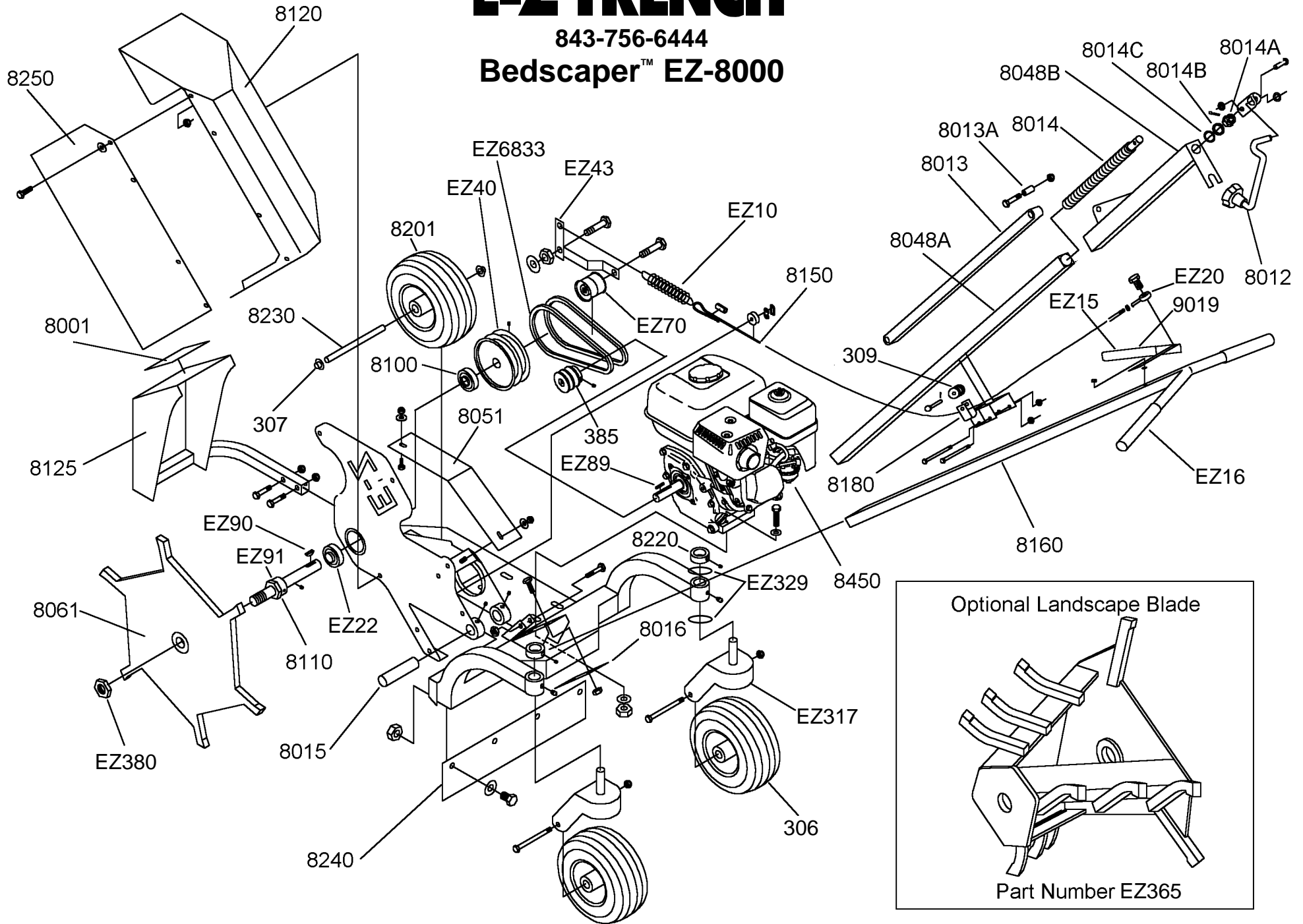

**Model EZ- 8000
PARTS LIST**

Part#	Description
EZ10	BELT TENSION SPRING
EZ15	IDLER LEVER
EZ16	HANDLE GRIPS
EZ20	CLEVIS FOR CABLE
EZ22	SEALED BEARING
EZ40	6" BLADE PULLEY
EZ43	BELT IDLER
EZ70	2 1/2" IDLER PULLEY
EZ89	3/16" X 1" SQUARE ENGINE KEY
EZ90	3/16" X 1" OUTPUT SHAFT KEY
EZ91	CONCENTRIC LOCK COLLAR
EZ317	CASTER
EZ329	CASTER SHIMS
EZ365	LANDSCAPE BLADE
EZ380	3/4" SAE NUT
EZ6833	1/2" x 33" POWERATED BELT
306	REAR WHEELS
307	PUSH CAP
309	NYLON CABLE PULLEY
385	2 1/4" ENGINE PULLEY
8001	DANGER STICKER
8012	DEPTH CONTROL LEVER
8013	DEPTH LINKAGE ROD
8013A	3/8" x 2" BOLT AND BUSHING FOR JACK LINKAGE
8014	DEPTH CONTROL ROD
8014A	CASTLE NUT
8014B	BRASS BUSHING
8014C	JACK SHIM
8015	LINKAGE PIN
8016	SPACER PLATE
8048	COMPLETE JACK
8048A	BOTTOM JACK ASSEMBLY
8048B	TOP JACK ASSEMBLY
8051	BELT GUARD
8061	CARBIDE BLADE
8110	OUTPUT SHAFT
8120	BLADE SHIELD
8125	BLADE GUARD
8150	COMPLETE CABLE
8160	HANDLE BAR
8180	QUICK BELT ADJ. ASSY.
8201	FRONT WHEEL
8220	LOCKING CAP
8230	FRONT AXLE
8240	FRAME DEBRIS DEFLECTOR
8250	SHIELD DEBRIS DEFLECTOR
8450	ENGINE
9019	HANDLE COVER

TERMS AND CONDITIONS OF SALE

USE:

E-Z TRENCHER IS DESIGNED TO TRENCH IN SOIL ONLY. ANY OTHER USE IS AT THE RISK OF THE OWNER.

PRICES:

Prices are subject to change without notice and will be invoiced at prices in effect on date of order.

CHANGES:

E-Z TRENCH MANUFACTURING, Inc. reserves the right to discontinue items, change specification, design, or prices at any time, without notice and without incurring any obligation whatsoever.

FREIGHT POLICY:

All orders are F.O.B., Loris, South Carolina, USA. Title to goods and risk of loss passed in Loris, South Carolina.

DAMAGED OR LOST SHIPMENTS:

All shipments must be carefully inspected. In case of damaged or loss, accept the shipment, but have carrier note damages or loss on delivery receipt. If it is concealed damage, call carrier for inspection. Make claim for damage with carrier.

LIMITED WARRANTY:

The E-Z Trencher is warranted against defects in workmanship or materials for a period of one year. Blades, bits, belts and bearings, which are normal wear items, are not warranted. This warranty covers replacement of parts only, no consequential damages are covered. In the event of a warranty claim contact E-Z Trench Manufacturing Company, Inc. This warranty does not include products which have been subject to improper use, or application, or misuse, neglect or accident; nor does it attend to products which have been repaired or altered by other than E-Z Trench Manufacturing Company, Inc. All warranty repairs are F.O.B., Loris, S.C., U.S.A. E-Z Trench Manufacturing Company, Inc. will not be responsible for any transportation charges.

THERE IS NO OTHER EXPRESS WARRANTY. TO THE EXTENT PERMITTED BY LAW ALL IMPLIED WARRANTIES INCLUDED THOSE OF MERCHANTABILITY AND FITNESS FOR A PARTICULAR PURPOSE ARE EXCLUDED. LIABILITY FOR CONSEQUENTIAL DAMAGES UNDER ANY AND ALL WARRANTIES ARE EXCLUDED TO THE EXTENT THAT EXCLUSION IS PERMITTED BY LAW. Some states do not allow limitation on how long an implied warranty lasts, and some

TERMS AND CONDITIONS OF SALE CONTINUED

states do not allow the exclusion or limitation or incidental or consequential damages, so the above limitation and exclusion may not apply to you. This warranty gives you specific legal rights and you may also have other rights which may vary from state to state.

E-Z Trench Manufacturing Company, Inc. does not warrant the engine but the purchaser must look to engine manufacturer for the warranty of the engine.

NORMAL WEAR:

Warranty will not cover repair where normal use has exhausted the life of a part. Trenchers, like all mechanical devices, need periodic parts replacement and service to perform well. It should be remembered that the service life of any trencher is dependent on the care it receives and the conditions under which it has to operate. Trenchers operate in harsh conditions, which can cause what appears to be premature wear. Such wear, when caused by rocks or other abrasive material, is not covered by warranty.

E-Z TRENCH WARRANTY DOES NOT COVER ABUSE OR NEGLIGENCE:

1. Bent or broken parts; Such damage is normally the result of abuse, such as striking a solid object with the cutting blade.
2. Broken parts, which results from excessive vibration caused by loose engine mounting, loose cutting blades, unbalanced blades, improperly attaching equipment to trencher, overspeeding or abuse in operation.
3. Misuse, neglect, improper operation, damage or abuse.
4. Alteration or removal of name plates or serial numbers.
5. Modification or change of this product outside the factory.

STANDARD TERMS:

1. C.O.D./F.O.B., Loris, SC, USA
2. Cash, money order, certified check, or wire transfer with order.
3. 30 day with approved credit.

All sales are final with no right to return, price protection or implied consignment. No person, including agent, representative, or employee of E-Z TRENCH MANUFACTURING, Inc. is authorized to assume for E-Z TRENCH MANUFACTURING, Inc. any obligation or liability concerning terms or conditions of sale other than that expressly stated herein.

EFFECTIVE MARCH 1, 1985

TROUBLE SHOOTING

PROBLEM

SOLUTION

IRREGULAR OR EXCESSIVE BELT WEAR

1. ENGINE PULLEY WORN OUT.
2. BELT TENSION TOO TIGHT.
3. RATE OF DIG IS TOO FAST FOR SOIL CONDITION.
4. CHECK FOR PULLEY MISALIGNMENT.
5. USING OTHER THAN FACTORY BELTS.

EXCESSIVE VIBRATION

1. LOOSE, BENT, OR BROKEN DIGGING BAR OR BIT.
2. LOOSE ENGINE MOUNT BOLTS.
3. ENGINE R.P.M. SHOULD BE 3800 R.P.M.

HOUSING CLOGGING

1. HOUSING BLOCKED BY FOREIGN OBJECT.
2. SOIL IS TOO WET.

DAMAGED DIGGING BLADE

1. STRIKING HARD OBJECTS, SUCH AS BRICKS, LARGE ROCKS, AND STEEL OBJECTS.

MAINTENANCE SCHEDULE

Perform at every indicated month or operating hour interval, whichever comes first.	Every Use	First month or 20 Hrs.	Every 3 months or 50 Hrs.	Every 6 months or 100 Hrs.
Check blade and bits*	○			
Check belt tension	○			
Check engine oil & air filter	○			
Tighten loose bolts		○		
Change engine oil		○		○
Snug castle nut on top of jack		○		○
Grease casters			○	
Check tire pressure			○	
Clean air filter or replace			○	